

This document is property of Aqua-Turf International, Inc. and is not to be reproduced, stored in a retrieval system, or transmitted in any form or by any means, electronic, mechanical, photocopying, recording, or by any information storage and retrieval system, without the prior written permission of Aqua-Turf International, Inc.

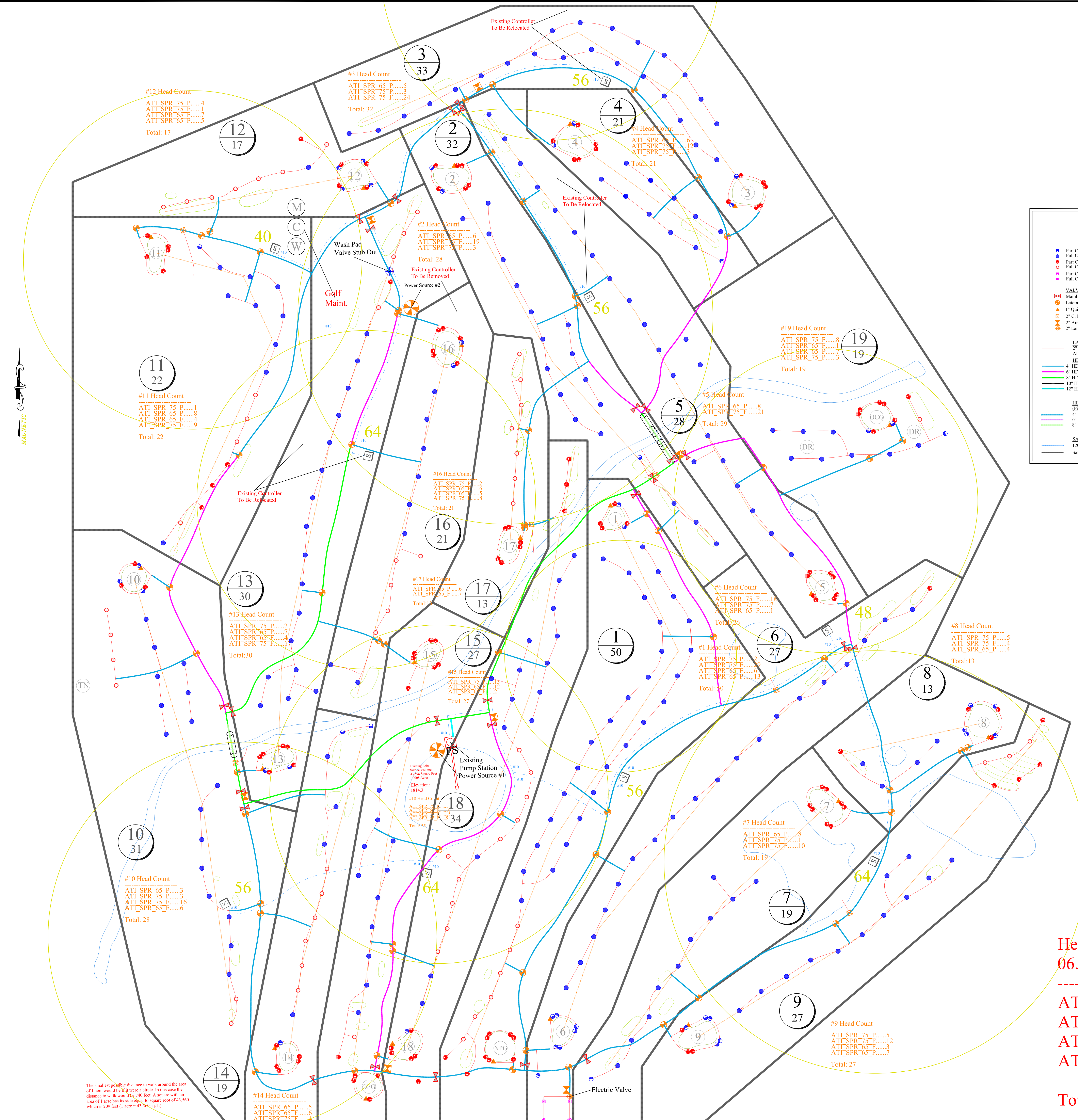

AQUA TURF INTERNATIONAL
200 Pleasant Run Rd
Smyrna, TN 37167
Phone: (561) 371-1815
www.aquaturfintl.com



LEGEND

VALVE - IN - HEAD SPRINKLERS TOTAL (475)

- Part Circle Toro 8558-55 V-4-H Sprinkler, 75' Spacing @ 60/65 psi (48)
- Full Circle Toro 8558-55 V-4-H Sprinkler, 75' Spacing @ 60/65 psi (239)
- Part Circle Toro 8558-54 V-4-H Sprinkler, 65' Spacing @ 60/65 psi (127)
- Full Circle Toro 8558-54 V-4-H Sprinkler, 65' Spacing @ 60/65 psi (61)
- Part Circle Toro 8335-31 V-4-H Sprinkler, 30' - 50' Spacing @ 60/65 psi (0)
- Full Circle Toro 8335-31 V-4-H Sprinkler, 30' - 50' Spacing @ 60/65 psi (0)

VALVES

- Mainline Gate Valve (26)
- Lateral 90 Degree Valve Assy. (60)
- 1" Quick Coupling Valve (21)
- 2" C. I. Drain Valve (5)
- 2" Air Relief Valve Assy. (7)
- 2" Landscape Auto Valve (1)

LATERAL PIPE

- 2" HDPE SPR 13.5
- All Sprinkler Lateral Pipe is 2" (36,700 L.F.)

HDPE MAINLINE PIPE

- 4" HDPE 4710 IPS - DR 13.5 Pipe - (14,000 L.F.)
- 6" HDPE 4710 IPS - DR 13.5 Pipe - (4,500 L.F.)
- 8" HDPE 4710 IPS - DR 13.5 Pipe - (2,660 L.F.)
- 10" HDPE 4710 IPS - DR 13.5 pipe - (0 L.F.)
- 12" HDPE 4710 IPS - DR 13.5 pipe - (60 L.F.)

HDPE CANAL/BIDGE CROSSING PIPE
(Pipe Shows Below is Not Reflected in Pipe Totals Above)

- 4" High Density Polyethylene DR 11 pipe - (0 L.F.)
- 6" High Density Polyethylene DR 11 pipe - (0 L.F.)
- 8" High Density Polyethylene DR 11 pipe - (240 L.F.)

SATELLITE CONTROL

- 120/240V Direct Burial Tray Cable Power Wire (6,000')
- Satellite Location Control Limits

Other Symbols:

- Zone Number (3, 4, 5, 6, 7, 8, 9)
- Stations within Zone (e.g., 33, 21, 19, 19, 28, 13, 13, 27, 13, 34, 19, 27, 19, 27)
- Pump Station (PS)
- Power Source(s) (2)
- Road/Bridge/Canal Crossing (0/2)
- Hole Number (10, 11, 12, 13, 14, 15, 16, 17, 18, 19)
- Satellite Locations (Existing / (C)Relocate)
- Spare Wire
- Indicates Tail Assembly Attached Sprinkler - Decrease in Range 6', Radius 31', Adnl. Flow 3.0 gpm @ 80 psi

BUTTERNUT CREEK GOLF COURSE
BLAIRSVILLE, GEORGIA
GOLF IRRIGATION DESIGN

SCALE
1"=100'

DATE - 10.03.17

DESIGN BY - TAH

DRAWN BY - TAH

FILE NAME
ATI Butternut Creek 100317.dwg

PROJECT NO.
012-617

REVISION	DATE

**Head Count
06.28.17**

ATI_SPR_75_P.....48
ATI_SPR_65_F.....61
ATI_SPR_75_F.....239
ATI_SPR_65_P.....127

Total: 475